

బాలాజి నివాస్

ఇండిపెండెంట్ హౌస్



కేవలం రూ 15.30 లక్షలకే మీ
సొంత ఇంటి కల నిజం
చేసుకోండి

Low Cost Rich Locality

BALAJI NIVAS



Site : Beside Keshava Reddy Residential School,
Opp. Safa Engineering College, Nandyal Road, Kurnool

www.mssrealestatesknl.com

SPECIFICATIONS

Foundation Structure: R. C. C Framed structure.

Walls: Red Brick with cement mortar.

Doors : Main door in teak wood frame and teak wood Shutters. All internal doors with countrywood with flush shutters.

Windows: Countrywood frames with countrywood shutters with glass for shutters with safety grills.

Flooring: Vitrified tiles.

Painting: Emulsion paint for internal walls and quality emulsion for external walls.

Kitchen: Granite platform with built in sink and tiles for walls up to 2'0" above the platform and provision for exhaust fan.

Shelves: 150 sft will be provided for each house.

Sanitary: Ceramic tiles flooring and tiles for walls up to door Level height with 1W.C in one toilet and one European W.C in one toilet with quality fitting.

Water Supply: Over head tank will be provided in site and 500 ltrs PVC tank will be provided for each house

Electricity: Concealed copper wiring & switches of quality make telephone and T.V. Points in Hall

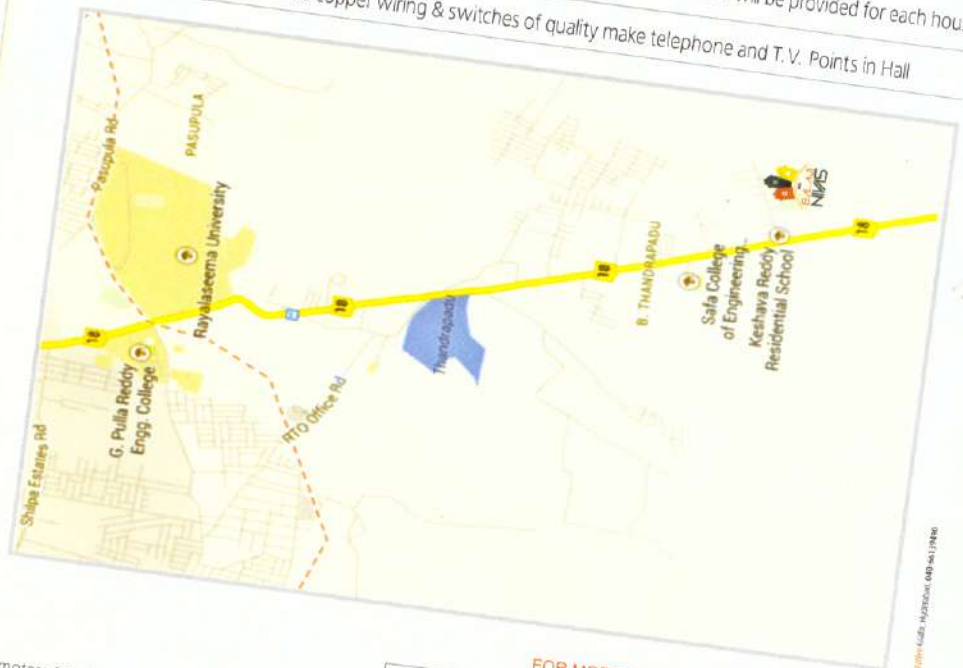

Plot No. 1,
Second Floor,
Balaji Complex,
Silpa Birla Compound,
Kurnool.

FOR MORE DETAILS CONTACT

Bame
9100327071

www.mssrealestatesknl.com



**WEST
FACING PLAN
TYPE C**

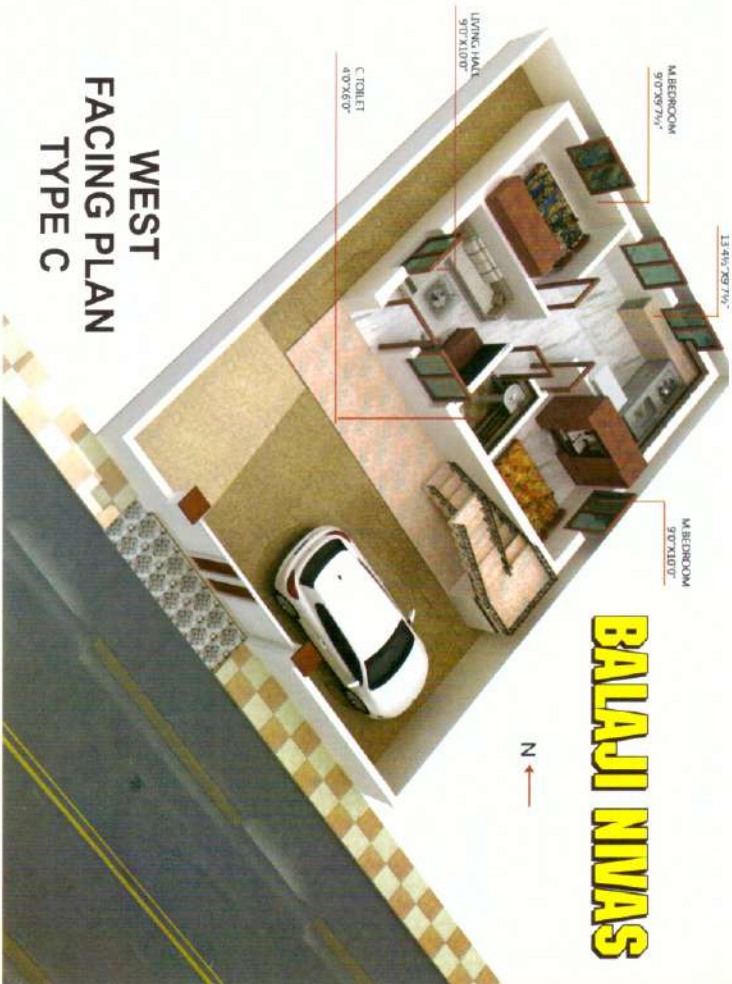

**EAST
FACING PLAN
TYPE C**

