



Plot Area:  
29'.0" x 45'.00"



Ground Floor  
Plinth Area :  
1008.00 sft.

www.mssrealtors.com

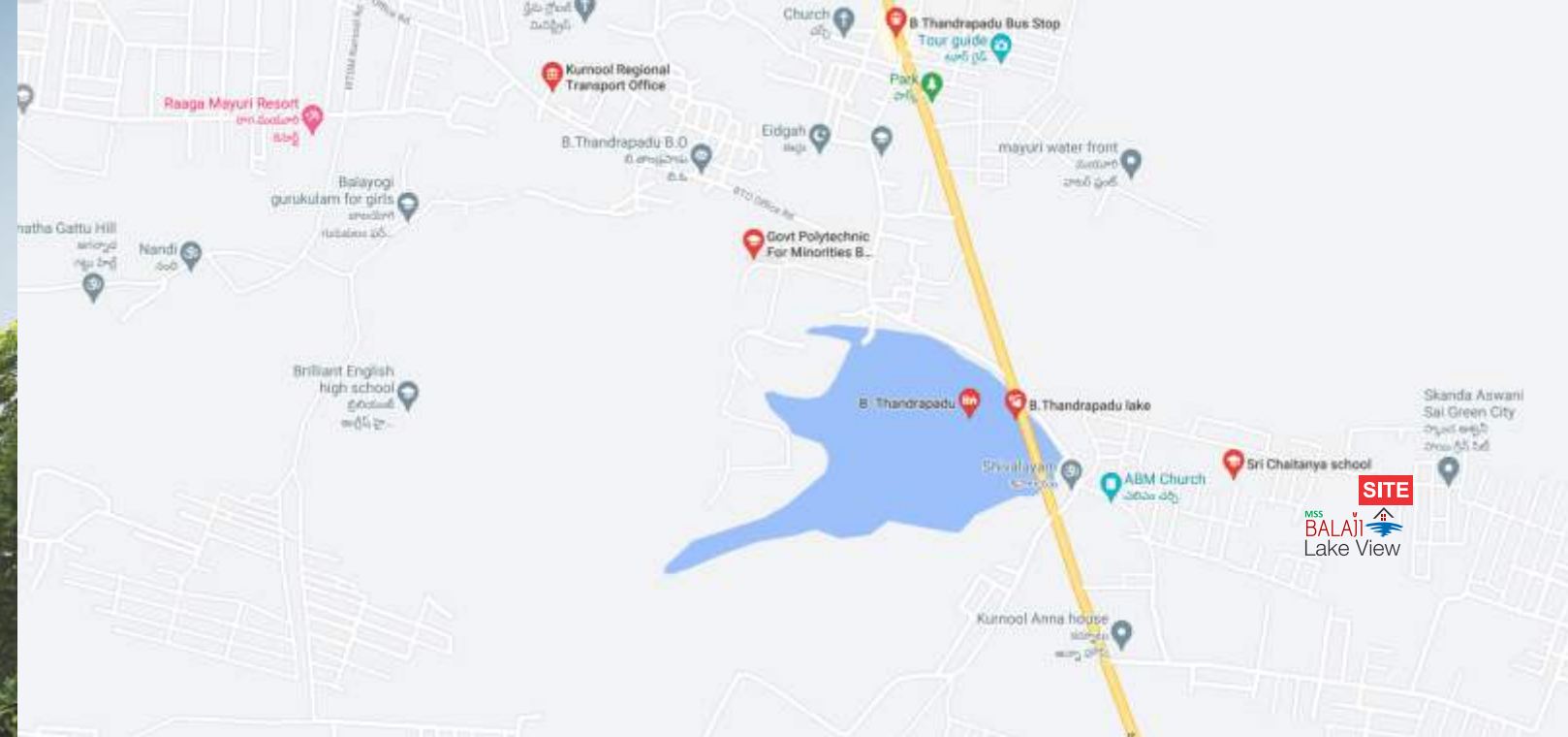

**S P E C I F I C A T I O N S**

- Foundation Structure**  
R.C.C Framed structure.
- Walls**  
Red Brick with cement mortar.
- Doors**  
Main door in teak wood frame and teak wood Shutters. All internal doors with teak frames with flush shutters.
- Windows**  
UPVC Windows with tinted glass and MS safety grills.
- Flooring**  
Vitrified tiles.
- Painting**  
ALLTECK finishing with emulsion paint for internal walls and quality emulsion for external walls.
- Kitchen**  
Granite platform with built in sink and tiles for walls up to 2'0" above the platform and provision for exhaust fan.
- Shelves**  
200 sft will be provided for each house.
- Sanitary**  
Ceramic tiles flooring and tiles for walls up to door Level height with 1W.C in one toilet and one European W.C in one toilet with quality fitting. Wash basin in dining hall only.
- Water Supply**  
Over head tank will be provided in site and 1000 ltrs pvc tank will be provided for each house
- Electricity**  
Concealed copper wiring & modular switches electrical points – modular type, telephone and TV points in hall. AC provision point in M.bed room.

Promoters & Builders



**MSS REALTORS**  
Plot No. 1, 2nd Floor,  
Shilpa Birla Compound,  
KURNOOL-518002.

Note : This brochure is only a conceptual presentation of the project and not a legal offering, the promoters reserve the right to make changes in plans, specification and elevations as deemed fit.

www.mssrealtors.com

**PROJECTS HIGHLIGHTS**

- ▶ Clear Title
- ▶ CC Roads with drainage facility
- ▶ Overhead Water tank for total layout
- ▶ Childrens play area
- ▶ Designer Street Lamps
- ▶ Vaastu compliant
- ▶ Housing loan facility from reputed banks.

NOTE: To be borne by purchaser only  
 1 Registration charges, GST, Building Approval Expenses & All Government Taxes.  
 2 Electrical meter charge has to be borne by customer.  
 3 Soft furnishing, Furniture & gadgets are not part of offering.  
 Any other additions to the specifications will be done at extra cost.

**ENGINEERS & ARCHITECTS  
GAYATHRI ASSOCIATES**

DVR Complex, Opp. More Super Market, NR Peta,  
Kurnool.  
Er. P. Murali Mohan Rao : 9440225959  
Er. S. Kishore Kumar : 9440290234



Experience a New Dimension  
*by Luxury Living*



**MSS**  
**BALAJI**  
**Lake View**  
NANDYAL ROAD @ KURNOOL

www.mssrealtors.com

Member of  
**CREDAI**  
Confederation of Real Estate  
Developers Association of India

Creative Grafik, Hyderabad, 040-461139490



Plot Area:  
29'.0" x 55'.00"

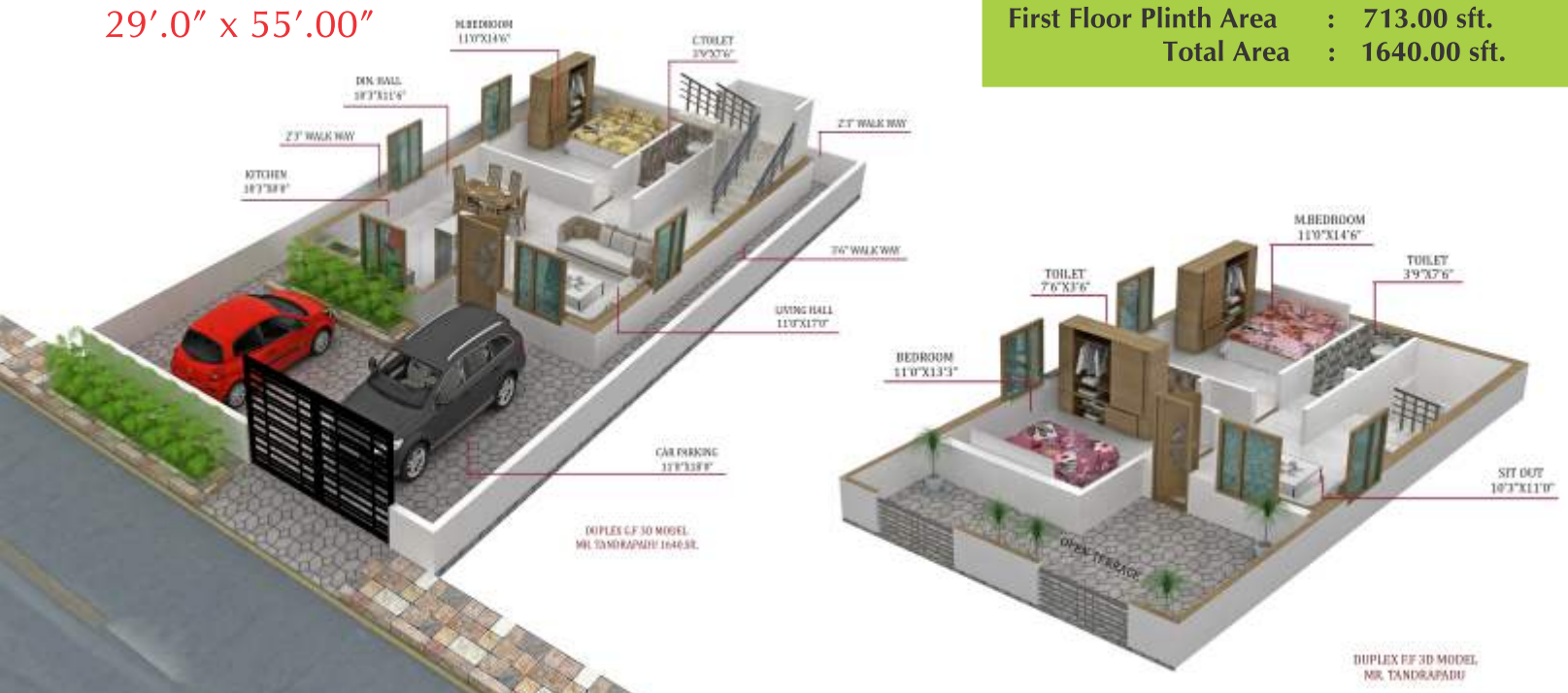

Ground Floor Plinth Area : 927.00 sft.  
First Floor Plinth Area : 713.00 sft.  
Total Area : 1640.00 sft.

Plot Area:  
29'.0" x 45'.00"



Ground Floor Plinth Area : 832.00 sft.  
First Floor Plinth Area : 652.00 sft.  
Total Area : 1484.00 sft.

Plot Area:  
29'.0" x 45'.00"



Ground Floor Plinth Area : 843.00 sft.  
First Floor Plinth Area : 641.00 sft.  
Total Area : 1484.00 sft.